

# Illuminated Snap Acting Push Button Switch

Part No. 17PBA31023

Back to [Illuminated Pushbutton](#) Main Page



## SPECIFICATIONS

CIRCUIT	: SPDT
CURRENT RATING	: 12mA
VOLTAGE RATING	: 24 VDC
TEST VOLTAGE	: 150V
CONTACT RESISTANCE	: 50 mΩ Max (initial)
INSULATION RESISTANCE	: 100 MΩ min.
OPERATING FORCE	: 170gf ± 50gf
TOTAL TRAVEL	: 2.5mm ± 0.2mm
OPERATING LIFE	: 500,000 cycles min.
SOLDER SPECIFICATION	: 256°C for 5 seconds
FUNCTION	: Momentary
OPERATING TEMPERATURE	: +10°C ~ +60°C

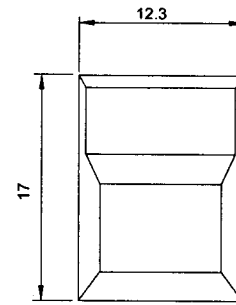
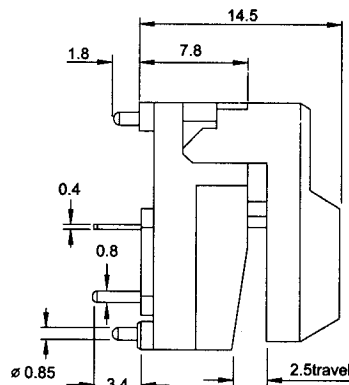
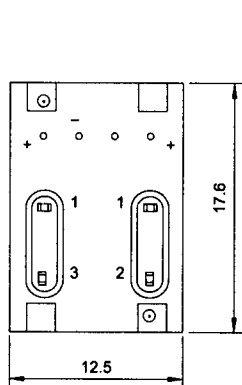

(SP86-A)

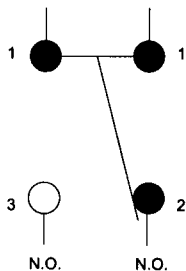

SPDT  
CONTACT CONFIGURATION

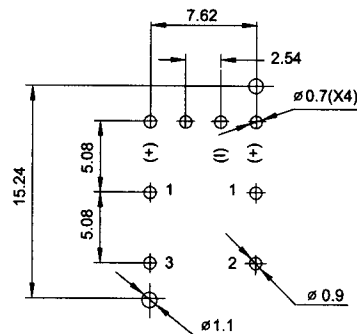

P.C.B. Mounting Holes

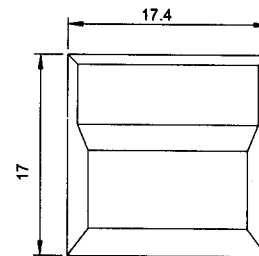

(SP86-B)